

A black and white photograph of five business professionals in a meeting. A woman stands in the center, holding a large document. A man stands to her right, leaning over the table. Two other people are seated at the table, looking at the document. The background shows a modern office with large windows.

# Gesamtschule der Stadt Menden

Einrichtungsplanung und Ausführung des gesamten Neubaus

Einzelbüro / Sekretariat / Teambüro / Multifunktionsraum / Klassenräume / Cafeteria

# Multifunktionsraum

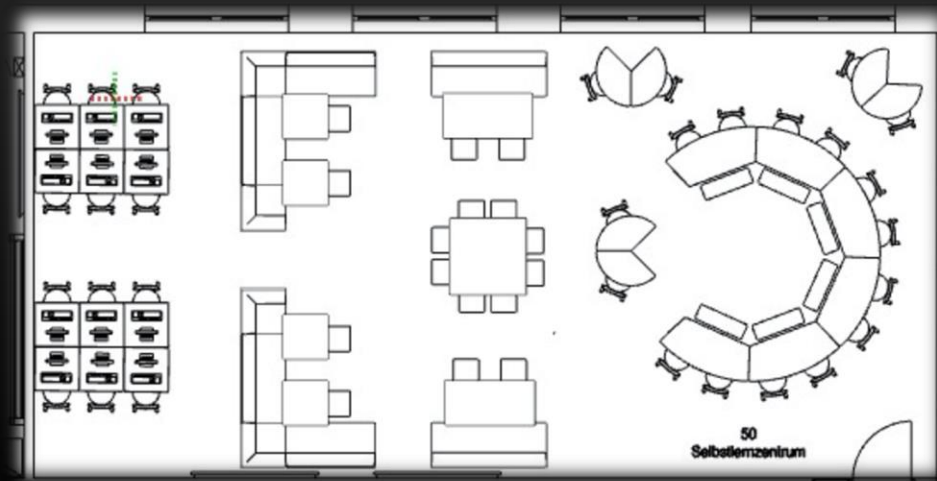
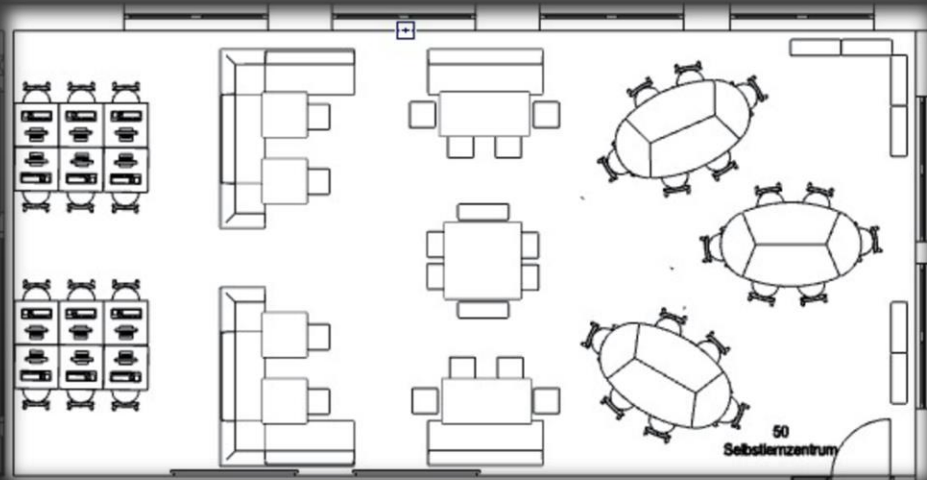

Bepflanzung



Oberflächen

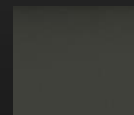
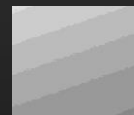

Farbakzente

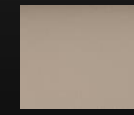

Lern,- + Ruhebereiche

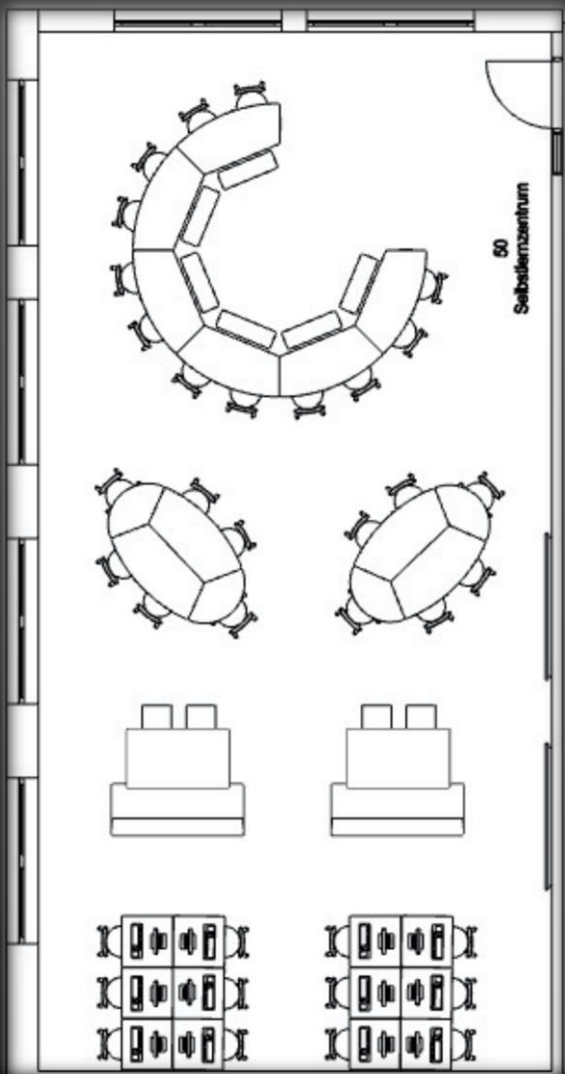
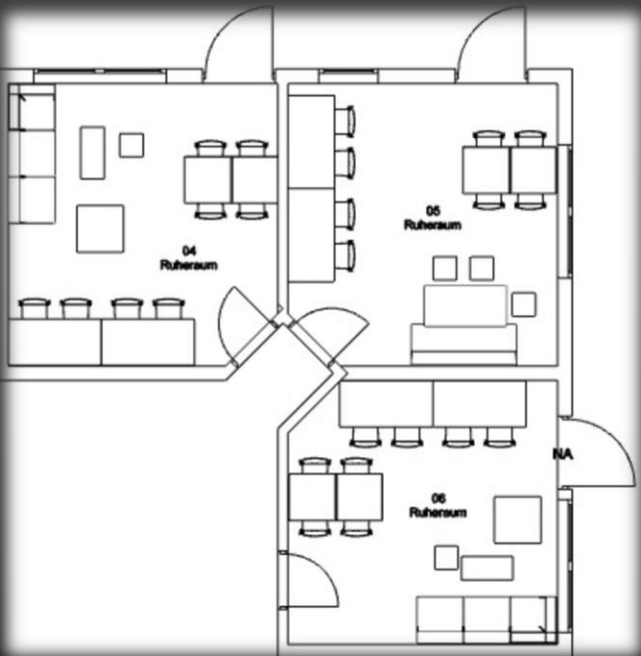

Oberflächen

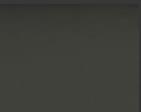

Farbakzente

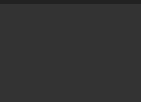
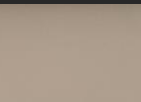



## Cafeteria + Musikraum + Aufenthalt

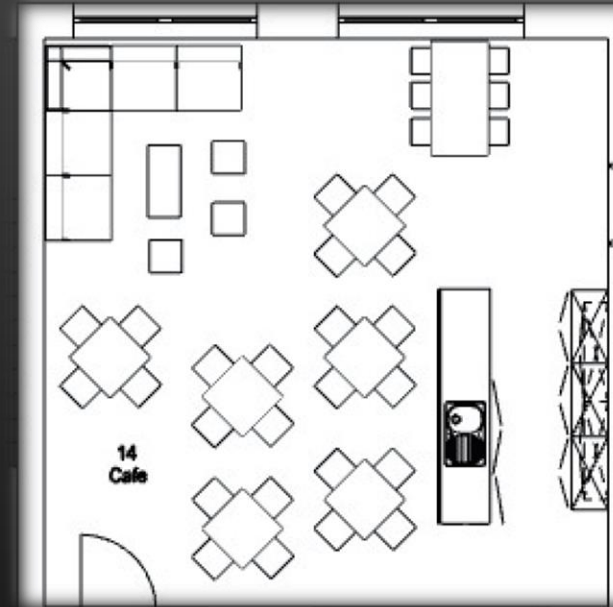
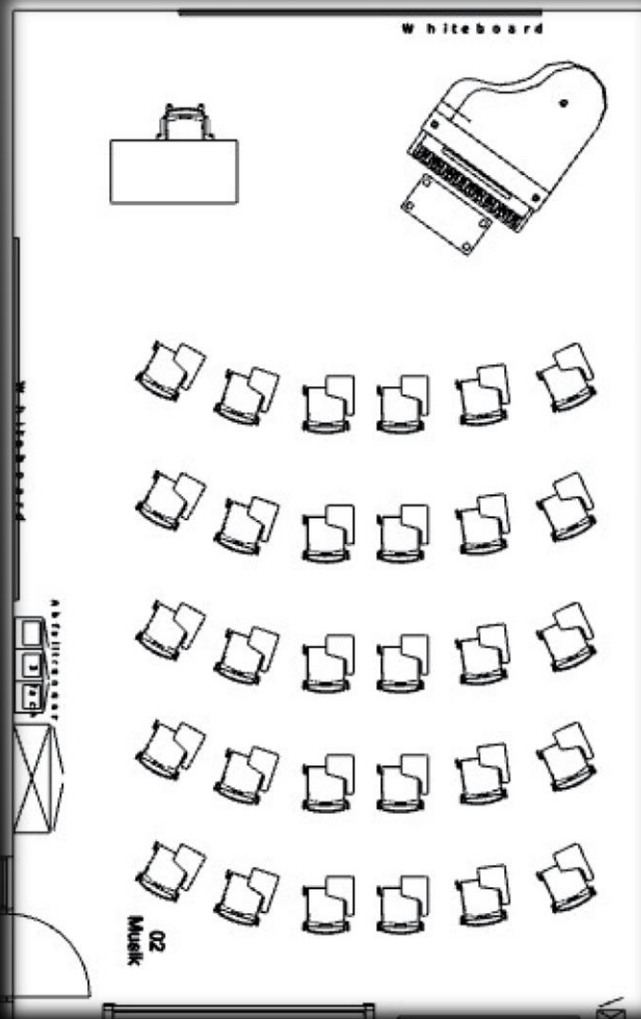

Oberflächen

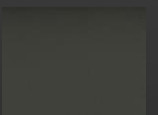

Farbakzente

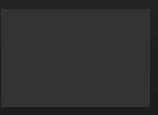



Wir bedanken uns ganz herzlich für diesen  
schönen Auftrag!

Grothe Büroeinrichtungen GmbH – Mendener Straße 89 – 58675 Hemer